

HELICOPTER

PARTS LIST

Your Action Man Helicopter has been designed for easy snap together assembly. Shown are illustrations of all the parts and their names. Follow the easy steps and illustrations when assembling your helicopter. Attach the colourful decals to the helicopter in the areas shown in illustration. Peel the decals off the backing and carefully place on the helicopter parts, as shown in illustration No 17 overleaf.

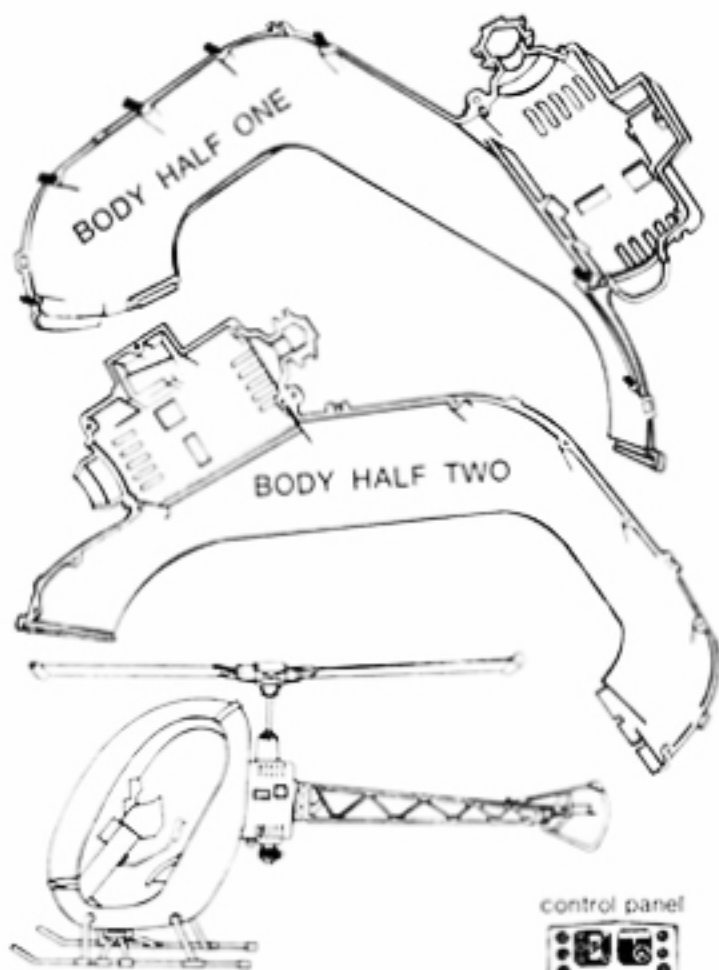

ROTOR BLADES

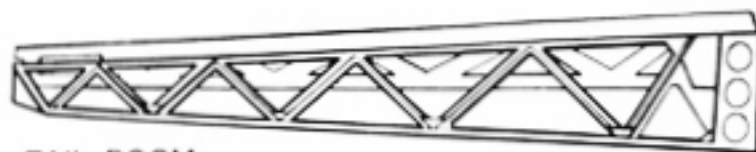

TAIL BOOM

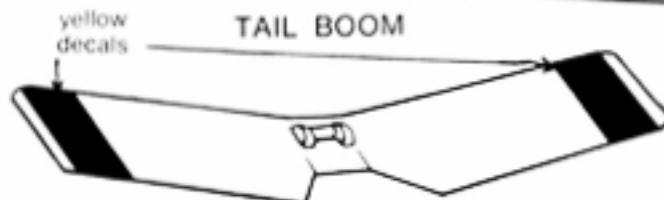

STABILISER

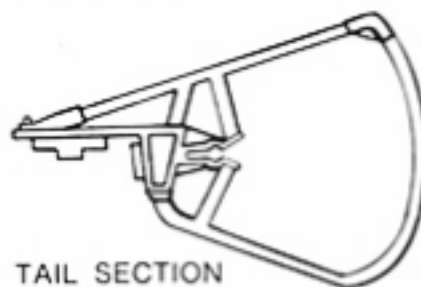

TAIL SECTION

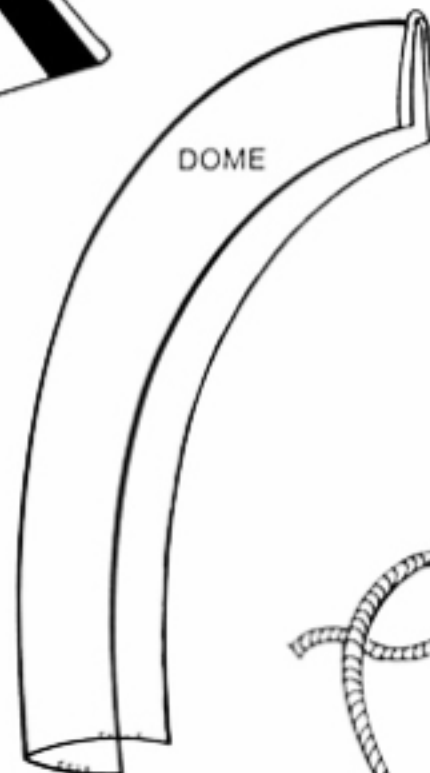

DOME

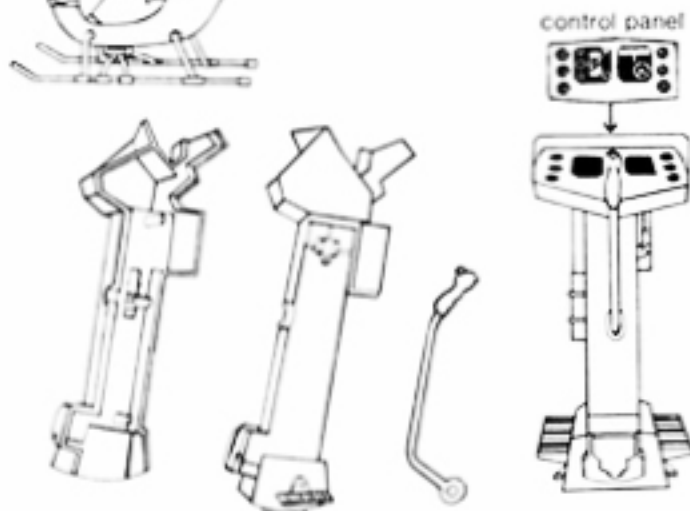

CONTROL PANELS

CONTROL STICK

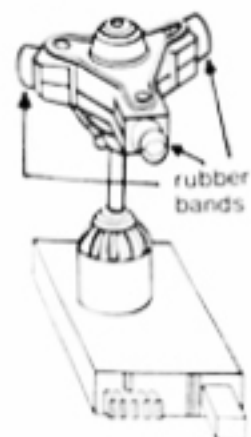

MOTOR ASSEMBLY

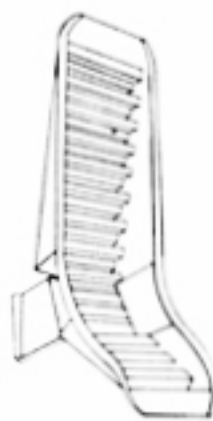

SEAT

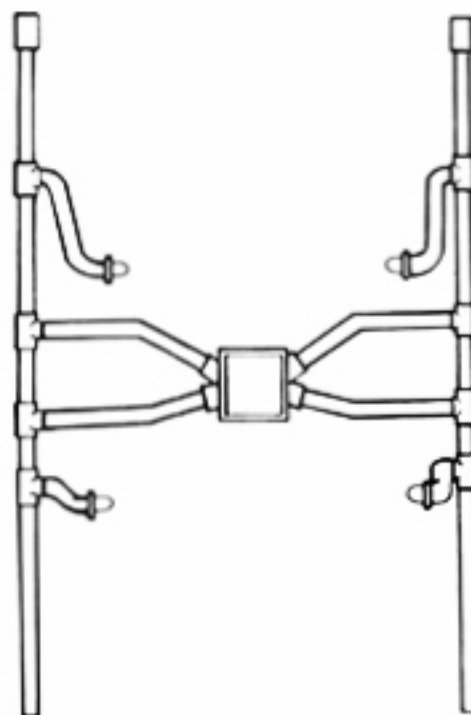

LANDING GEAR



WINCH STRING



WINCH HOOK



WINCH ROTOR

ASSEMBLY INSTRUCTIONS

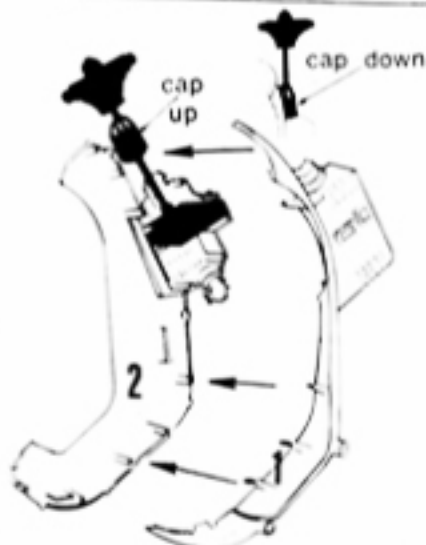

1. Insert motor assembly into body half marked 2 by lifting black motor cap up as shown in illustration.
2. Snap body half marked 1 into locating holes on number 2 body half, and press together firmly. See illustration. Slide black motor cap down over top of assembled body halves, as shown in illustration, and press into slots.

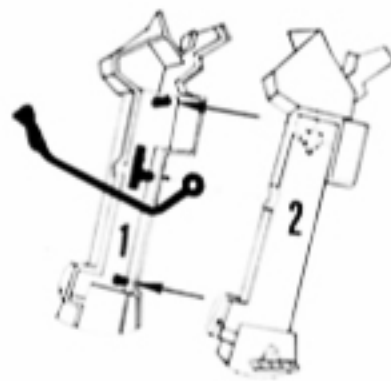

3. Place control stick over center pin of #1 half of control panel, as shown in illustration.
4. Place #2 section of control panel over #1 section and press together firmly, as shown in illustration. Control stick should have free movement.

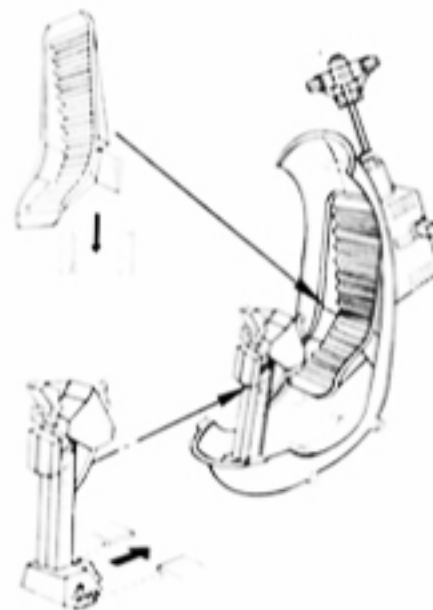

5. Slide seat into position in body section, as shown in illustration.
6. Slide assembled control panel into place in body, as shown in illustration.

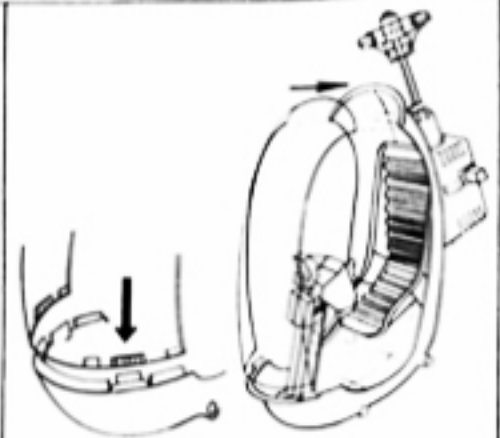

7. Attach dome to body by snapping bottom of dome into body, as shown. Snap top of dome into position by gently pulling top of body out and depressing and slipping top of dome into top lip of body as shown in illustration.

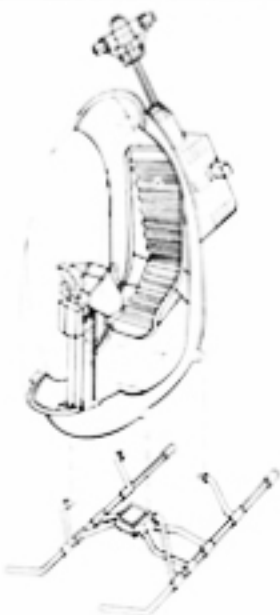

8. Attach landing gear to body and press in firmly as shown in illustration.

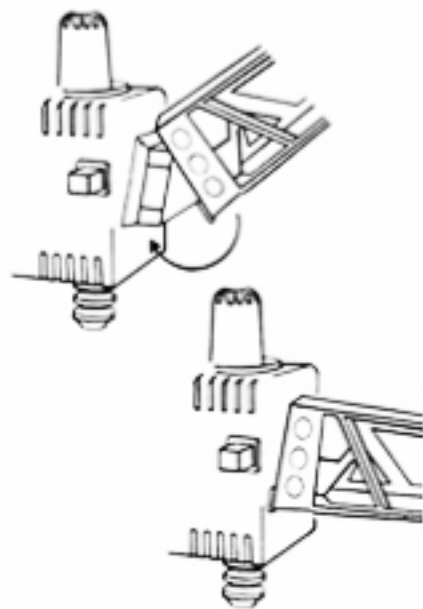

9. Snap tail boom onto rear of body, as shown in illustration.

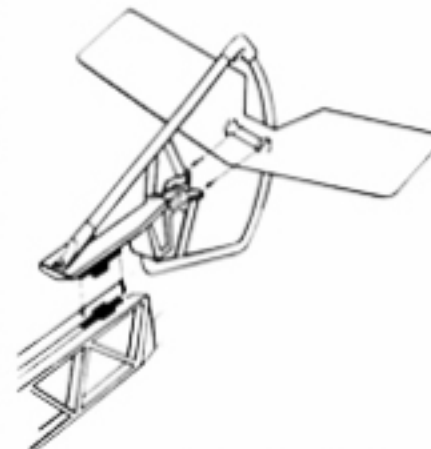

10. Slide stabiliser onto tail section, as shown in illustration.
11. Snap tail section into position on tail boom, as shown in illustration.

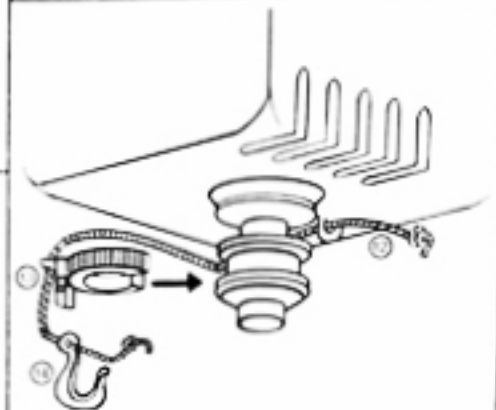

12. Tie a knot on one end of the piece of string, included in this set. Slide other end of string through eye underneath motor, as shown in illustration, and pull the string through until the knot on the other end of the string rests against the eye.
13. Thread end of string through eye in winch rotor, as shown in illustration, and snap winch rotor over winch housing, as shown in illustration.
14. Attach end of string to winch hook and tie knot, as shown in illustration.

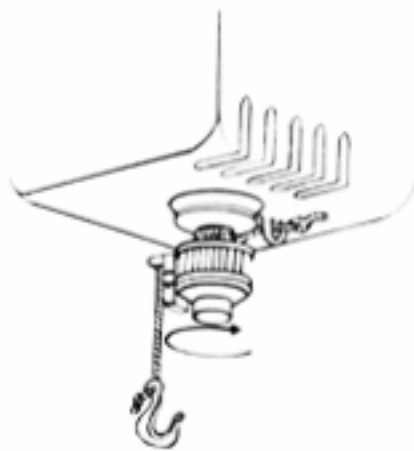

15. Turn winch rotor, as shown in illustration, and winch hook will be wound up. Unwind winch hook by turning winch rotor in opposite direction.

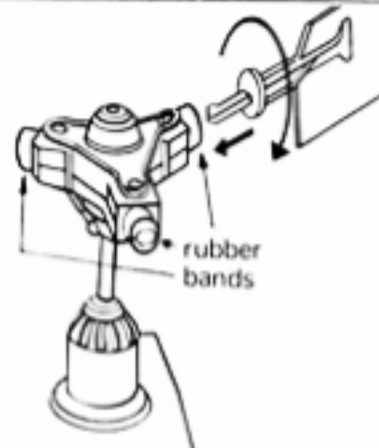

16. Before snapping rotor blades onto rotor, check that you have a rubber band at the end of each of the three arms. These hold the two halves of the rotor together. Hold rotor blades with blade facing downward, as shown, and snap into rotor housing. Twist blade to flat position.

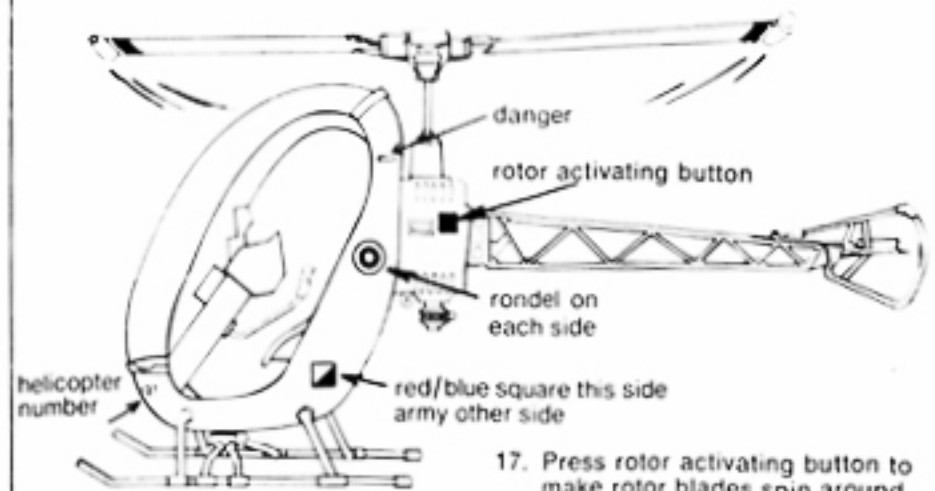

17. Press rotor activating button to make rotor blades spin around. Start the rotor blades spinning slowly at first, then gradually build up speed. The faster you press the button, the faster the rotor blades will spin. See illustration.

CAUTION:
Do not hold rotor activating button in while rotor blades are spinning.